

**General Product Information:**

ROXUL® products are mineral wool fibre insulations made from basalt rock and slag. This combination results in a non-combustible product with a melting point of approximately 2150°F (1177°C), which gives it excellent fire resistance properties. ROXUL mineral wool is a water repellent yet vapour permeable material.

**Description & Common Applications:**

The Roxul DrainBoard® product is a rigid mineral wool insulation board that is water repellent, durable and environmentally stable. This product is designed as a high-performance fibrous foundation drainage system. Its non-directional fibre structure, which allows the system to be installed either horizontally or vertically, provides superior water drainage from below grade foundation walls and structural concrete. DrainBoard is designed for use with a damp proofing layer for both residential and commercial application up to a depth of 12 ft (3.7m) below grade.

**Compliance and Performance:**

CAN/ULC-S702-97	Thermal Insulation Mineral Fibre for Buildings	Type 1, Complies
CCMC Evaluation Listing	MasterFormat 07212: Mineral Fibre Insulation Board	12610-L
CCMC Evaluation Listing	MasterFormat 02622: Foundation Drainage System	12718-R, Type 2

**Fire Performance:**

CAN/ULC S102	Surface Burning Characteristics	Flame Spread = 0
ASTM E 84(UL 723)	Surface Burning Characteristics	Smoke Developed = <5
		Flame Spread = 0
		Smoke Developed = 5

**Moisture Resistance:**

ASTM C 1104	Moisture Sorption	0.04%
-------------	-------------------	-------

**Compressive Resistance:**

ASTM C 165	≥1.5" at 10% deformation	17 kPa (355 lbs/ft <sup>2</sup> )
	<1.5" at 25% deformation	35 kPa (731 lbs/ft <sup>2</sup> )

**Corrosive Resistance:**

ASTM C 665	Corrosiveness to Steel
ASTM C 795 ****	Stainless Steel Stress Corrosion Specification as per Test Methods C871 and C692: U.S. Nuclear Regulatory Commission, Reg. Guide #1.36: U.S. Military Specifications MIL-I-24244 (all versions including B and C)

**Thermal Performance:**

ASTM C 518 (C 177)	R-value/inch @ 75°F	4.3 hr.ft <sup>2</sup> .F/Btu.in ***
	RSI value/25.4 mm @ 24°C	0.76 m <sup>2</sup> K/W

**Density:**

8 lbs/ft<sup>3</sup>

**Dimensions:**

Roxul Drainboard is available in 3' x 4' and 4' x 6' dimensions, and is offered as a non-stock item with a required minimum order quantity.

**Recommended Fastening:**

- 1-1/2" (40 mm) concrete nails with 3/4" (19 mm) washers
- Bitumen Sealing Compound
- All-Purpose Construction Adhesive or equivalent.

	<b>R4.3</b> Standard non-stock	<b>R5</b> Standard non-stock	<b>R10</b> Standard non-stock
<b>Thickness</b>	1"	1.25"	2.38"

# ROXUL DrainBoard®

## Installation:

Damp-proofing installed between insulation and foundation

Fasteners must be 4" from sides of board

Minimum 2% slope away from foundation

Backfill free of debris/boulders within 600 mm. from foundation

Not less than 150 mm crushed stone on top and sides of pipe or tile

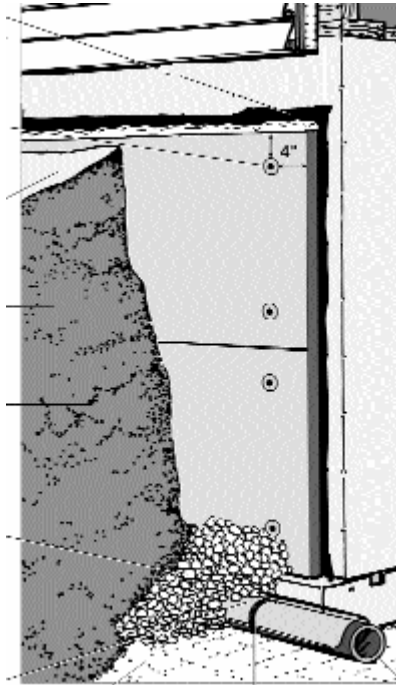

- DrainBoard must be installed over code approved dampproofing material.

- Apply DrainBoard sheets either horizontally or vertically to the foundation wall, ensuring that sheets are tightly butted together. Joints do not require caulking.

- Fasten DrainBoard sheets using approved nails with washers. Place fasteners 4" from the sides of the sheet, one at each corner. If using an adhesive, follow the manufacturer's application instructions.

- DrainBoard sheets may be cut to fit around windows or other irregularities providing that all below grade details, exposed to the soil are caulked along the line where DrainBoard material flushes with the foundation.

- Seal the top of the installation at grade level with a bead of construction grade caulking. This is to prevent soil from becoming trapped behind the sheets during backfill operations.

- Backfill operations can commence immediately after DrainBoard is installed, year round. If using an adhesive in place of mechanical fasteners, please consult the manufacturer's instructions for recommended setting time.

- Ensure finished grade is within 3" of the top of the DrainBoard sheets.

Drain pipe or tile must be on compacted soil

Pipe or tile joints must have 6-10 mm. open joints

Tile or pipe must be below bottom of floor slab

## Key Application Qualifiers:

- Water repellent
- Durability
- Ease of application
- Fire resistant
- Excellent thermal resistance
- Low moisture sorption
- Non-corrosive
- Chemically inert
- Does not rot or sustain vermin
- Does not promote growth of fungi or mildew
- CFC and HCFC free product and process
- Made from natural & recycled materials

## Other ROXUL Products:

Please consult ROXUL for all your insulation needs. We have an extensive range of products for all applications from pipe insulation to commercial products to residential batts. ROXUL invites all inquiries and will act promptly to service all of your requirements.

\*\*\*\*"Provisions for lot testing may be required, consult manufacturer."

Note:

As ROXUL Inc. has no control over installation design and workmanship, accessory materials or application conditions, ROXUL Inc. does not warranty the performance or results of any installation containing ROXUL Inc's. products. ROXUL Inc's. overall liability and the remedies available are limited by the general terms and conditions of sale. This warranty is in lieu of all other warranties and conditions expressed or implied, including the warranties of merchantability and fitness for a particular purpose.

**ROXUL INC.**  
[www.roxul.com](http://www.roxul.com)

**Milton, Ontario Tel: 905-878-8474**  
**Tel: 1-800-265-6878,**

**Fax: 905-878-8077**  
**Fax: 1-800-991-0110**

Revised: August 7, 2007  
Supersedes: June 1, 2007